

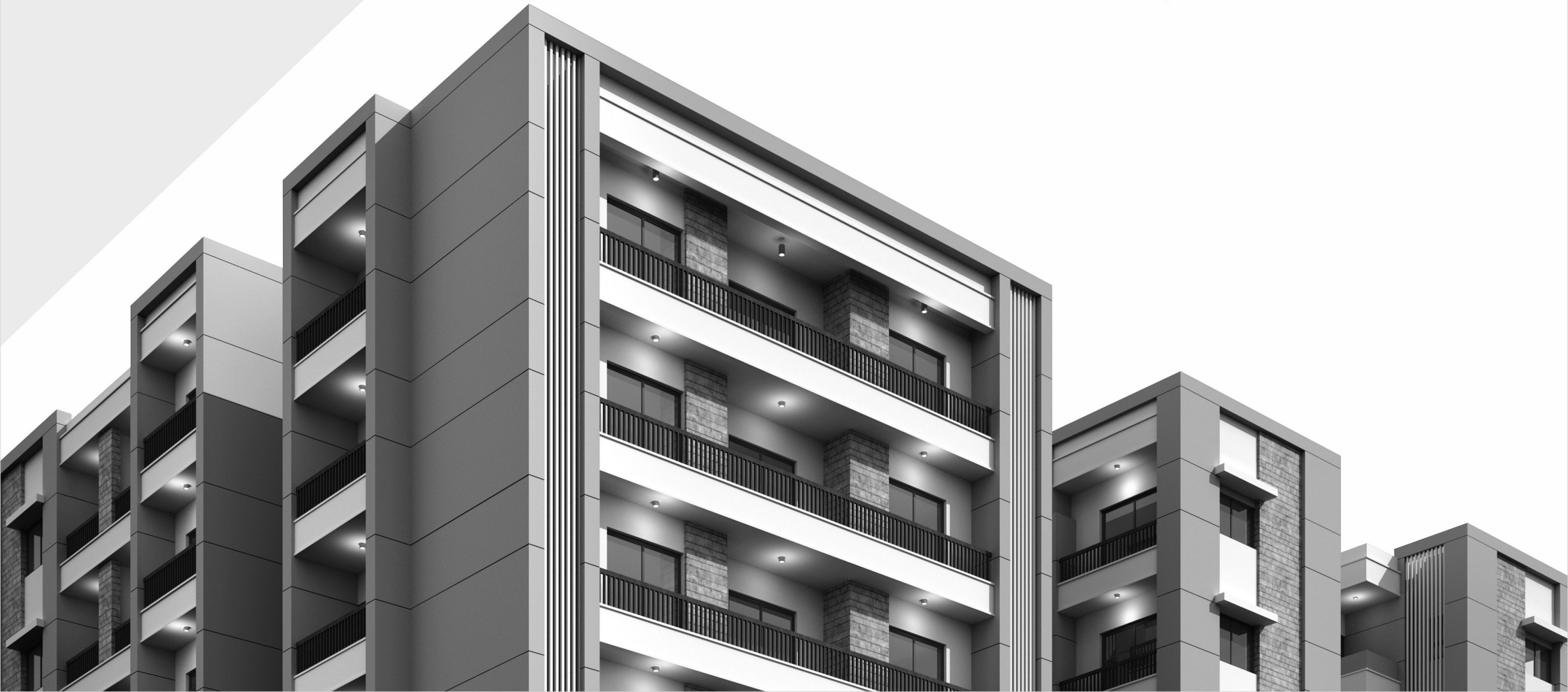

2 & 3 BHK APARTMENTS & SHOPS





Welcome to a delightful project offering lifestyle living.

A campus that offers its residents a world of comfort at the best value for their investment.

Located in one of Vadodara's most fast growing and upcoming residential areas of Jambuva, Shree Aarna Sky extends its feel good aura to encompass a lifestyle which is truly outstanding and blissful.

The campus offers spacious 2 & 3 BHK apartments and road facing ground floor shops in a premium finish.



Shree Aarna Sky tower has 3 towers facing a green landscaped garden and clubhouse. Simple yet aesthetic elevation and a small community provides this project a timeless beauty that is sure to grab instant attention.

An intelligent mix of textures and materials has resulted in a fine building that not only looks stylish but will also last the test of time. The spacious and thoughtful planning shall enable the residents to enjoy a lifetime of bliss.













ENTER
A WORLD LIKE
NO OTHER





AMENITIES

-  Landscaped garden
-  Clubhouse with indoor games area
-  Senior citizen's seating
-  Attractive name plate & elegant letter box
-  Solar electricity for common areas
-  Branded elevators with elegant interiors
-  Gated premises with CCTV security & video door phone
-  24 hours water supply
-  Automatic back-up generator for common areas

GROUND FLOOR PLAN



FIRST FLOOR PLAN



12 Mtr. Wide Road

TYPICAL FLOOR PLAN (2nd TO 7th)



TOWER - B & C

Typical Floor

— 2 BHK —

Built-up Area: 753 sq.ft.

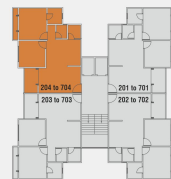

TOWER - A

Typical Floor

3 BHK

Built-up Area: 1034 sq.ft.

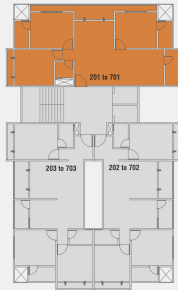

TOWER - A

Typical Floor

3 BHK

Built-up Area: 964 sq.ft.

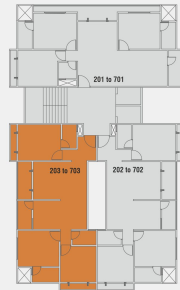
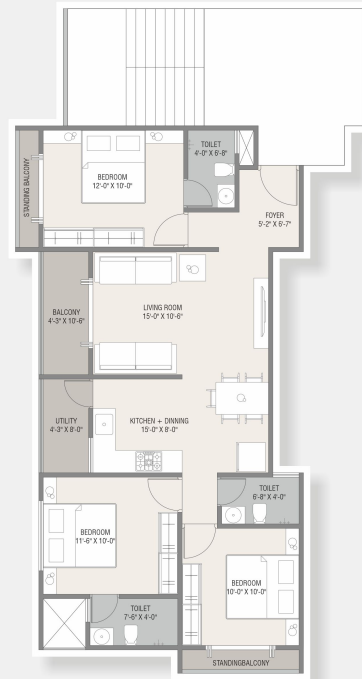



Specifications



Structure:
Well designed RCC frame structure as per structural engineer's design.



Flooring:
2' x 2' Vitrified flooring in living, dining, kitchen, balcony, and all bedrooms, and ceramic tiles in bathrooms.



Kitchen:
Granite platform with SS kitchen sink and designer tiles up to lintel level over the platform.



Bathrooms:
Designer tiles up to lintel level with quality bath fittings, sanitary ware and glazed tiles.



Plumbing:
Systematic wall concealed CPVC/UPVC branded plumbing fitting, Geyser point in Bathrooms.



Doors & Windows:
Decorative main door with standard safety lock and fittings. All other internal doors are flush doors with laminates. Aluminum section windows with reflective glass & safety grill.



Electrification:
Concealed copper ISI wiring and good quality modular switches with sufficient points. Provision for Split AC in master bedroom. Geyser point in bathroom. MCB in main distribution board.



Finishing:
Internal smooth finish plaster, 2-Coat Putty & Primer External waterproof plaster with semi-acrylic exterior paint. Railing with enamel paint & exterior weather resistant paint.

Shree Aarnā Sky

Developers: Shree Ambe Reality

Site: Shree Aarna Sky,
Besides St. Basil School,
Nr. Voltemp Company, Jambuva,
Vadodara - 390014

Email: shreeaarnasky410@gmail.com
Contact: +91 91578 36815

Architect:



Architecture • Planning • Interiors

Structure Consultant:



Keyplan



Shree Aarnā Sky



PAYMENT SCHEDULE FOR FLATS

Booking amount(inc.token)	10%
Agreement for Sale within 2 months of booking	20%
Plinth Level	07%
1st Floor Slab	08%
2nd Floor Slab	08%
3rd Floor Slab	08%
4th Floor Slab	08%
5th Floor Slab	08%
7th Floor Slab	08%
Plaster Level	05%
Flooring Level	05%
Before Sale Deed	05%

PAYMENT SCHEDULE FOR SHOPS

Booking Amount	10%
Agreement for Sale	15%
Plinth Level	20%
1st Slab Level	20%
Plaster Level	15%
Flooring Level	15%
Before Sale Deed	05%

RERA No.:

RERA Website: gujrera.gujarat.gov.in